

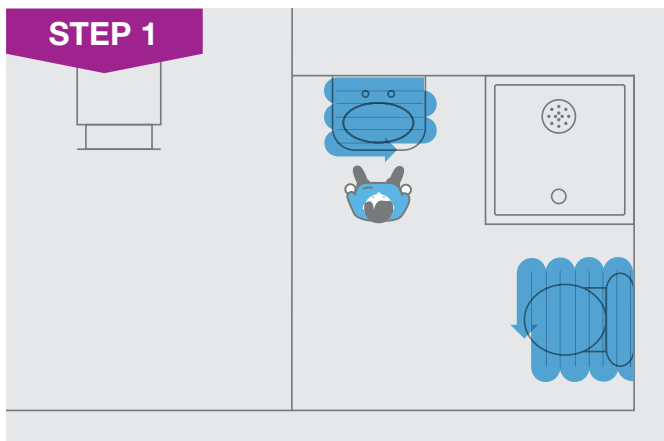

How to position Violet Room Sanitiser correctly - Part 1

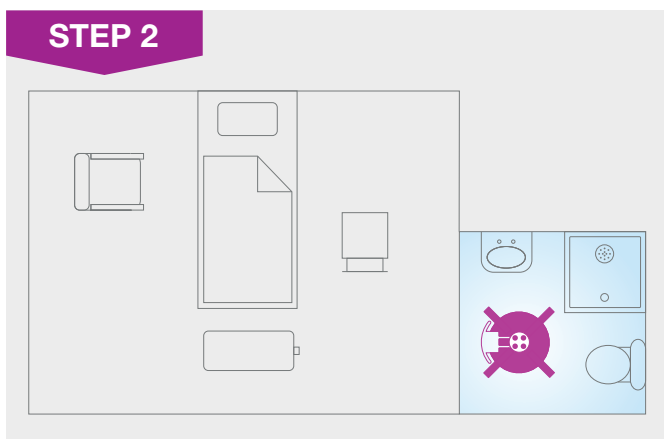

- Before using the UV unit you must perform regular cleaning as per local policy.
- This is to remove any visible soiling which may reduce the efficacy of the machine.
- Place the 'No Entry' barrier outside of the doors.
- If the room has a bathroom ensure it is also cleaned thoroughly before using the UV unit.



- Place the device as shown.
- Lift the toilet lid and seat.
- Set the device for 10 minutes and leave the room, ensure the door is closed behind you.

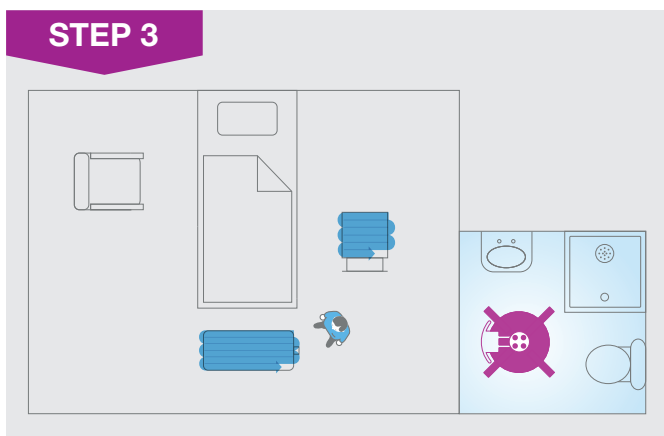

- Whilst the UV unit is disinfecting the bathroom perform a regular terminal clean in the room, as per local policy.

JBN220356



How to position Violet Room Sanitiser correctly - Part 2

STEP 4

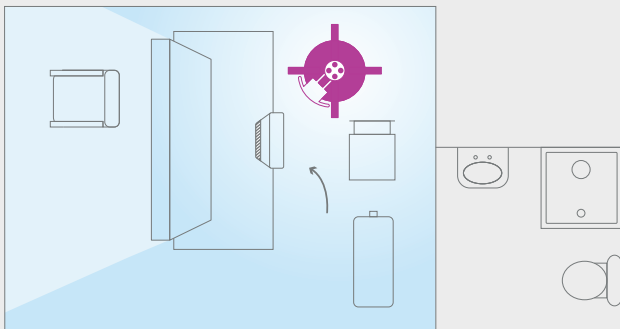

- Check that the machine cycle is complete and all four lamps show OK.
- Place the device in the room as shown.
- Move the bed away from the wall and roll the mattress to a 45° angle, lean on the left bed rails.
- Place the pillow(s) on the right bed rail in portrait position.
- If applicable, close bathroom door.
- Turn the bedside locker to face the wall as shown and open the door/drawers.
- Move the high touch devices (including telephone if present) to a new position to maximise exposure.
- Set the device for 10 minutes and leave the room.

STEP 5

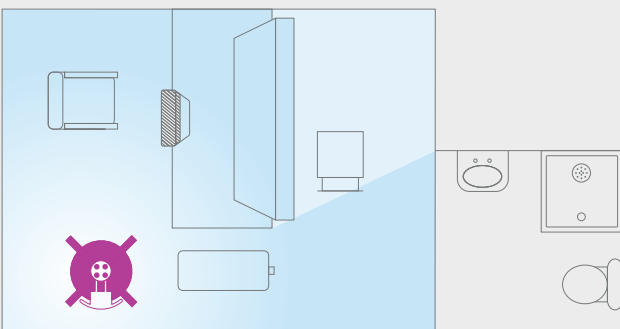

- Check that the machine cycle is complete and all four lamps show OK.
- Move the device to a new location as in the step 5 image.
- Raise the bed to its highest level and raise the cot sides.
- Lean the mattress on the right bed rail.
- Place the pillow(s) in a portrait position with exposed end down, flip so the unexposed side is facing towards the machine, lean on the left bed rail.
- Raise the patient table to its highest level and place as shown.
- Rotate the bedside locker.
- Ensure the nurse call button is placed in a position to maximise exposure to UV e.g. dangle over side of the bed.
- Place all high touch devices e.g. TV remote controls, in a position to maximise exposure.
- Set the device for 10 minutes and leave room.

STEP 6

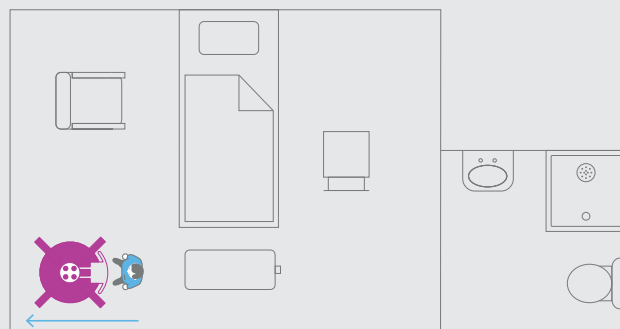

- Once the machine cycle is complete, and all four lamps show OK, enter the room.
- It will smell of ionization which is normal.
- Remove the UV unit from the room and place back in the UV cover.
- Use PPE if indicated by local policy and risk assessments.

JBN220356